



9 Grey Boots Circuit Kelso QLD

3 1 2

Set in a quiet, tightly held pocket of just 12 homes, this beautifully maintained family residence has been lovingly held by the same owners for over 30 years - a true testament to the appeal of both the home and its setting.

From the moment you arrive, the presentation impresses. Manicured lawns and established gardens frame the home, with native bushland rising above and beyond, providing a peaceful backdrop and regular visits from local wildlife, including the unmistakable call of resident kookaburras.

Step inside the solid brick home and you won't be disappointed. The sense of care and pride of ownership is immediately evident, with light modern tones, timber flooring, and a warm, welcoming atmosphere throughout.

Type : House
Price : Offers over \$850,000
Land Size : 5608 sqm
View : <https://www.nathanlynham.com/8618148>



Shelly Lynham
07 4723 3222



Graham Lynham
07 4723 3222

[For full version visit the website](https://www.nathanlynham.com)

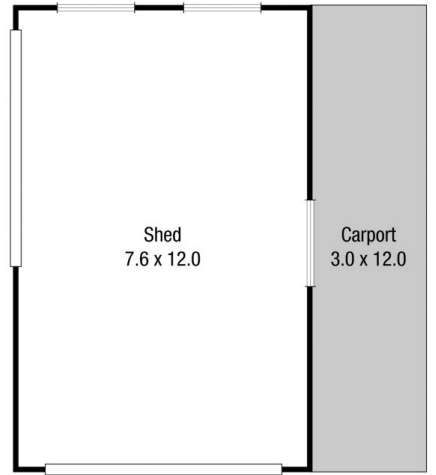
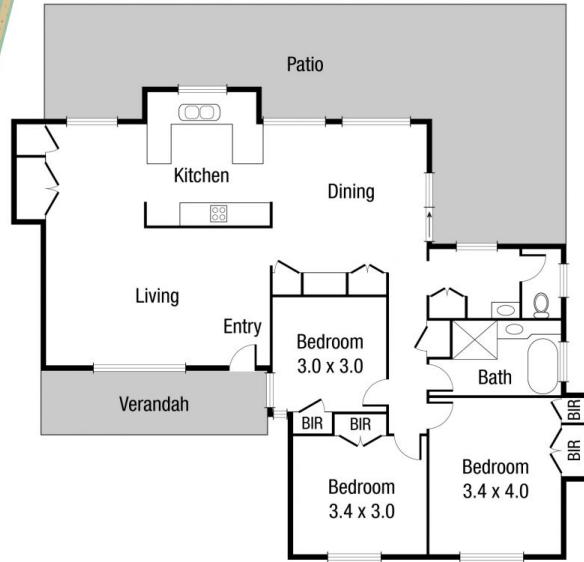
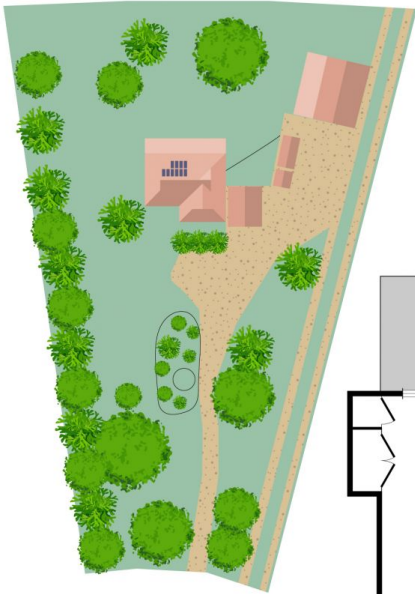

(Not In Position)

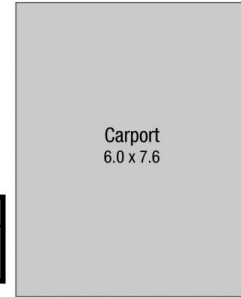

Scale in metres. Indicative only. Dimensions are approximate. All information contained herein is gathered from sources we believe to be reliable. However we cannot guarantee its accuracy and interested persons should rely on their own enquiries.

TOTAL AREA : 175.5 sq.m

9 Grey Boots Cct, Kelso