



9 Mclauchlan Crescent Kelso

 3  2  2

Timeless Tradition

Beyond the beauty of its inescapable Queenslander heritage, within the walls of this stunningly crafted home sits a raft of unparalleled contemporary interiors.

Presenting as a new home, it's a blend of old meets new.

It flows seemingly from the moment you enter the door.

Under high ceilings, the three bedrooms, including a generous-sized master with a stunning ensuite and walk-in robe, are enhanced by subtle tones and project a traditional presence that's warm and inviting.

The low-maintenance 791sqm allotment is fully fenced with a double-bay shed.

Under Contract By Nathan Lynham 0427695162

Type: House
Sold Date: 04/03/2024
Land: 791 m2

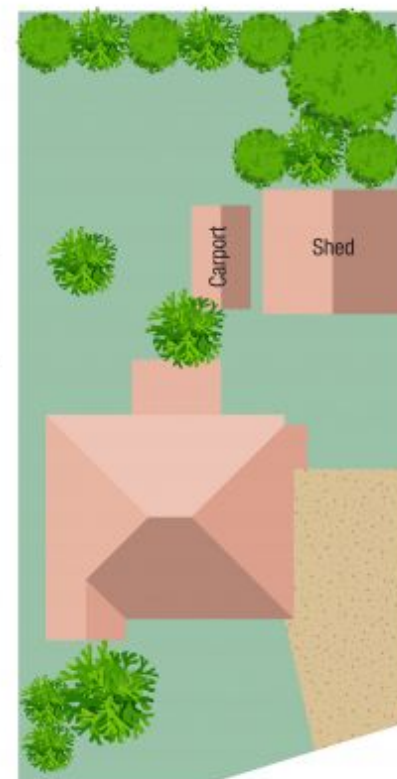
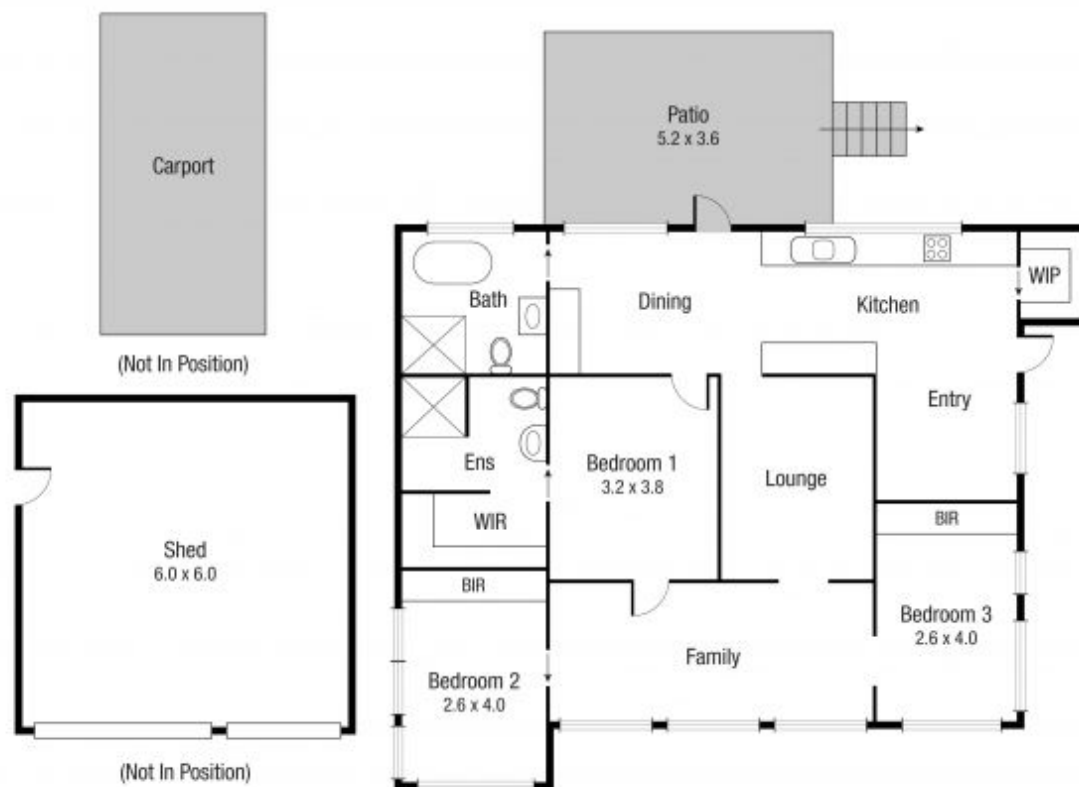

Scale in metres. Indicative only. Dimensions are approximate. All information contained herein is gathered from sources we believe to be reliable. However we cannot guarantee its accuracy and interested persons should rely on their own enquiries.

TOTAL AREA : 124.0 sq.m

9 Mclauchlan Cr, Kelso